

THIS COPY IS PROVIDED ON A RESTRICTED BASIS AND IS NOT TO BE USED IN ANY WAY DETRIMENTAL TO THE INTERESTS OF PANDUIT CORP.

PANDUIT PART NO. *	WEIGHT
MFFPEBL	.04 LB/EACH (20 g/EACH)

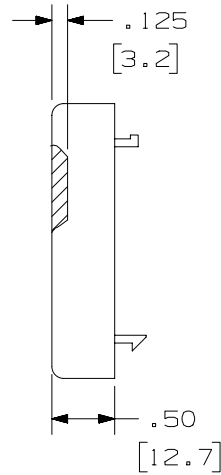
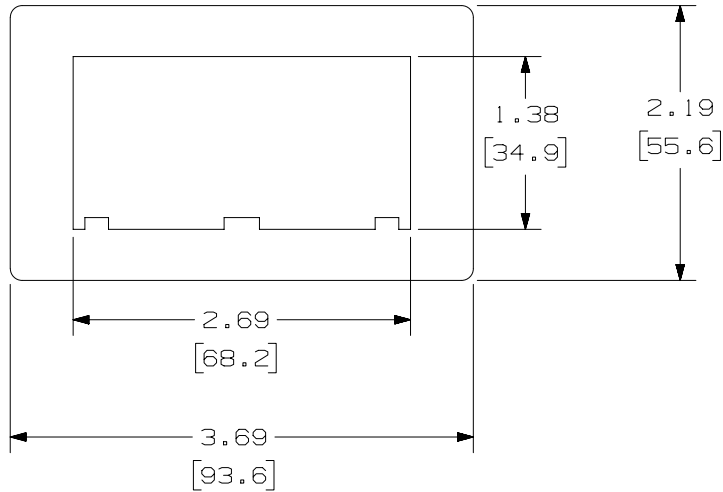

NOTES:

- * 1. SEE CURRENT CATALOG FOR ADDITIONAL PART NUMBER SUFFIXES TO INDICATE COLOR AND OR PACKAGE QUANTITY.
- 2. ACCEPTS PANDUIT MODULAR FURNITURE FACEPLATES WHEN DEPTH INSIDE MODULAR FURNITURE BASE IS LIMITED.
- 3. FITS INTO SAME BREAKOUT SIZE AS FACEPLATES.
- 4. DIMENSIONS IN PARENTHESES ARE IN METRIC.

CAD FILENAME/LAYERS D34518_MFFPEBL_C (D)

PANDUIT CORP. TINLEY PARK, ILLINOIS

MFFP FACEPLATE EXTENDER
(MFFPEBL)
CUSTOMER DRAWING

UNLESS OTHERWISE SPECIFIED,
DIMENSIONAL TOLERANCES ARE:
(.X) ± (.XXX) ± .010(.3)
(.XX) ± .03(.8) ANGLES ±

UNLESS OTHERWISE SPECIFIED,
ALL DIMENSIONS ARE GIVEN
IN INCHES, THIRD ANGLE PROJECTION.

DRAWN BY DW	MAT'L:	SCALE NONE
DATE 8-23-93		DRAWING NO. 34518-15
CHECKED BY		DWG A SIZE

REV	DATE	BY	CHK	DESCRIPTION	ECN	CHK	CUST	SUP
R	8-23-93	DW		RELEASED TO PRODUCTION	34518-15			